

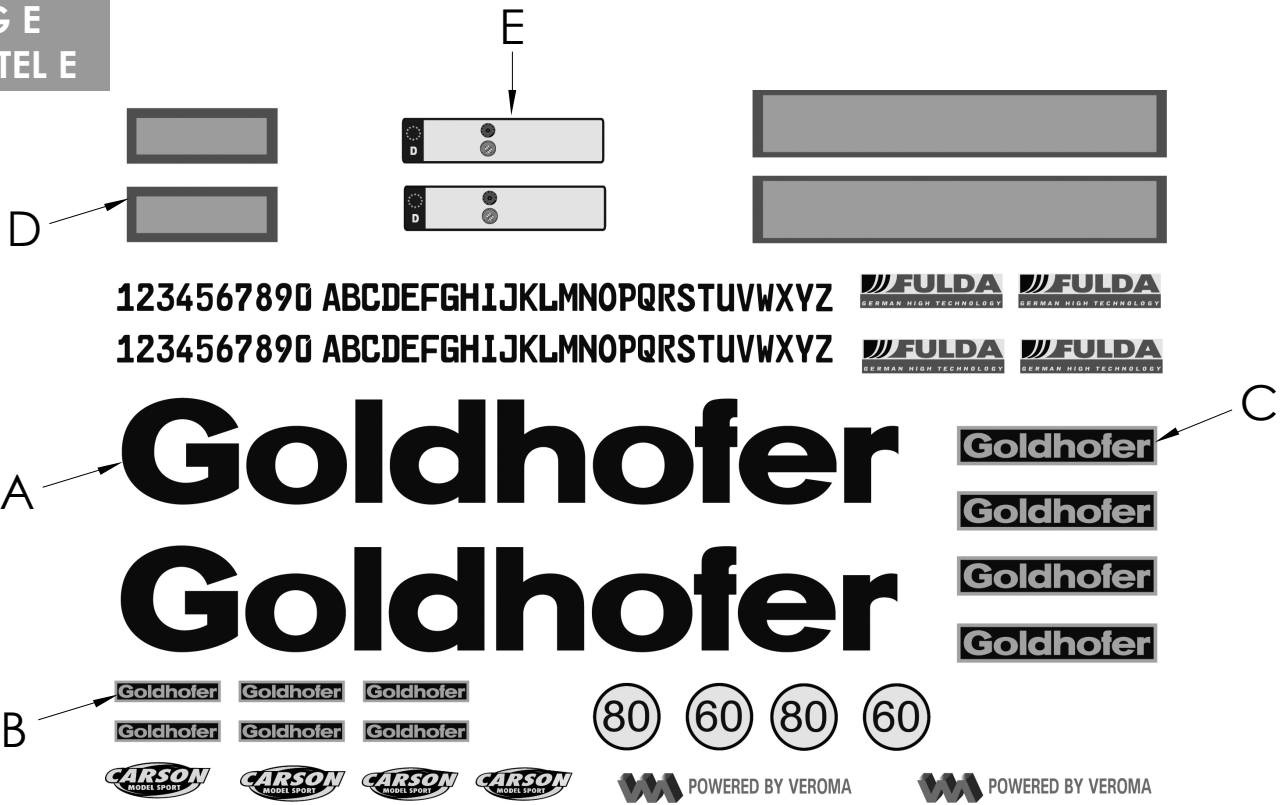

1:14 GOLDHOFER
SATTELAUFLIEGER /
1:14 GOLDHOFER
LOW LOADER
BAU STN-L3

E
BAG E
BEUTEL E



READ BEFORE ASSEMBLY

Study and understand the instructions thoroughly before beginning assembly. To prevent trouble and finish the product with good performance, it is important to assemble each step exactly as shown.

ERST LESEN DANN BAUEN

Vor dem Zusammenbauen schauen Sie sich gründlich die Bauanleitung an. Um Ärger zu vermeiden und um das Produkt gut fertigzustellen, befolgen sie die Schritte der Anleitung.

**TOOLS REQUIRED
BENÖTIGTE WERKZEUGE**

Screwdriver (Size small)
Schraubenzieher (Größe klein)



Modeling knife
Modelliermesser



Hex wrench (Size 1,5 mm; 2 mm; 2,5mm 3mm)
Imbusschlüssel (Größe 1,5 mm; 2mm; 2,5mm; 3mm)

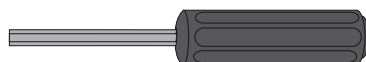

Long nose pliers
Flachzange

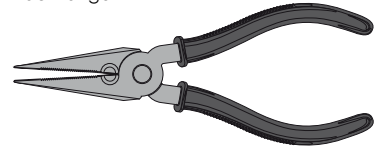

Side cutter
Zwickzange

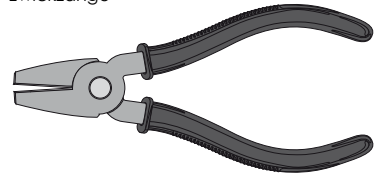

Box wrench
Steckschlüssel

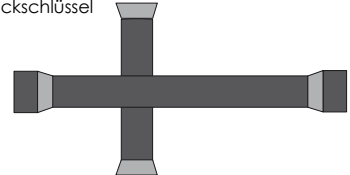

Instant cement
Sekundenkleber

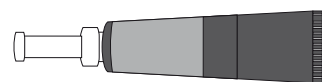

Grease
Fett

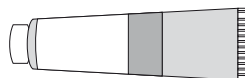

A 1 ~ 4
BAG A
BEUTEL A

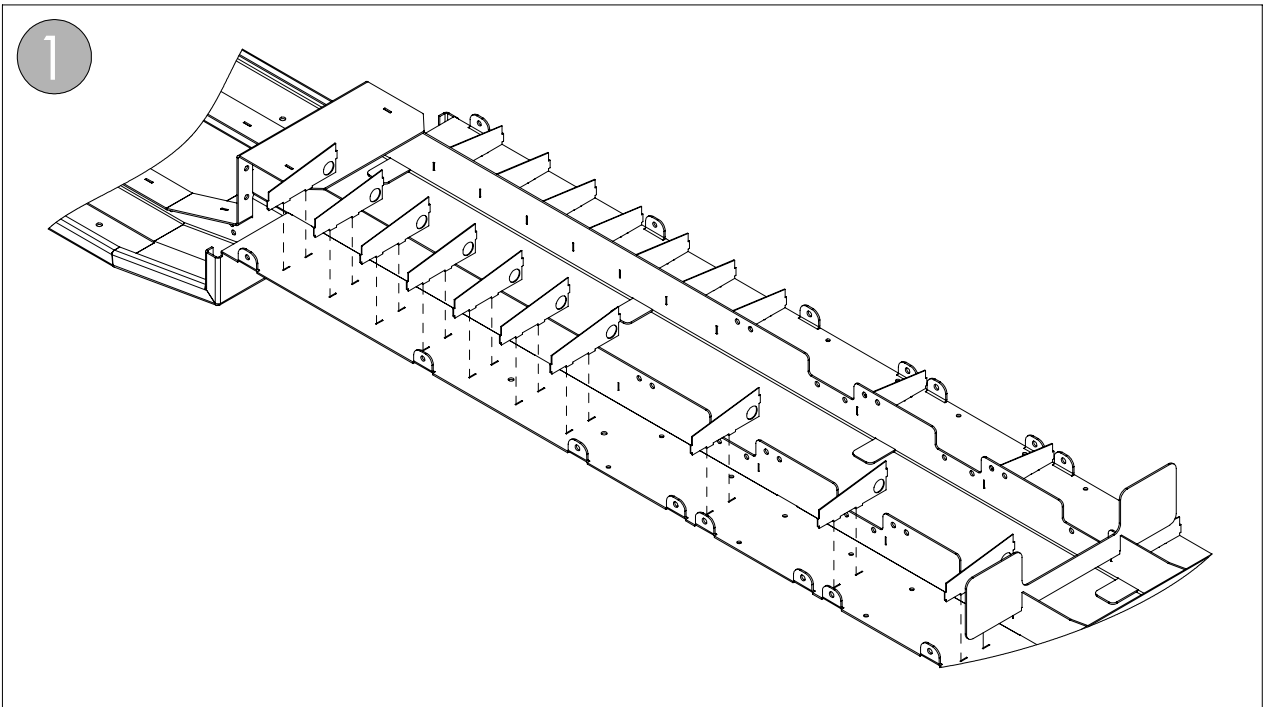

3 mm
Nutmutter



AA3 x 18

3 mm
Washer
Bellagscheibe



AF1 x 12

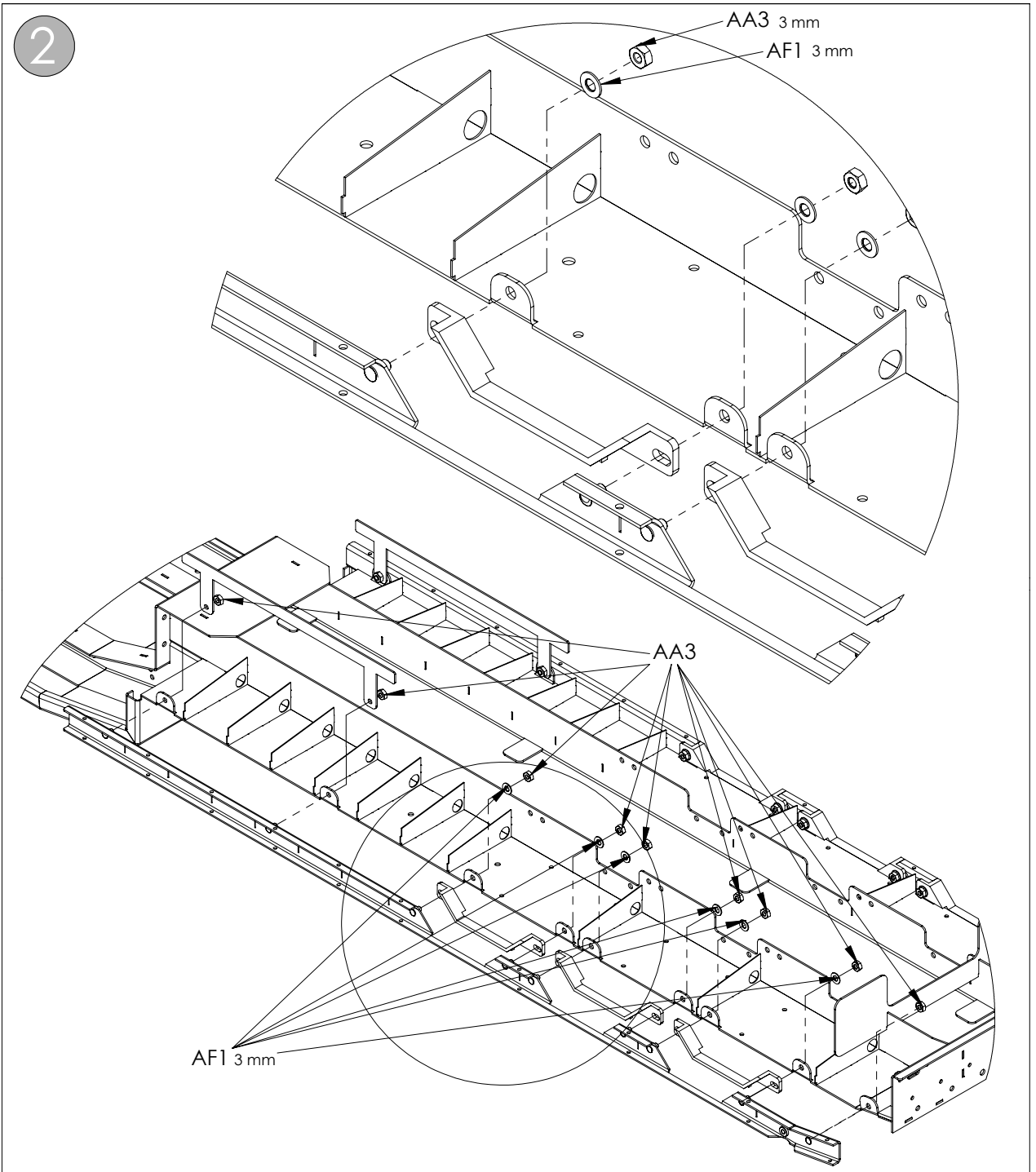

3

3x6 mm
Screw
Schraube



AB1 x 4

3 mm
Nut
Mutter



AA3 x 4

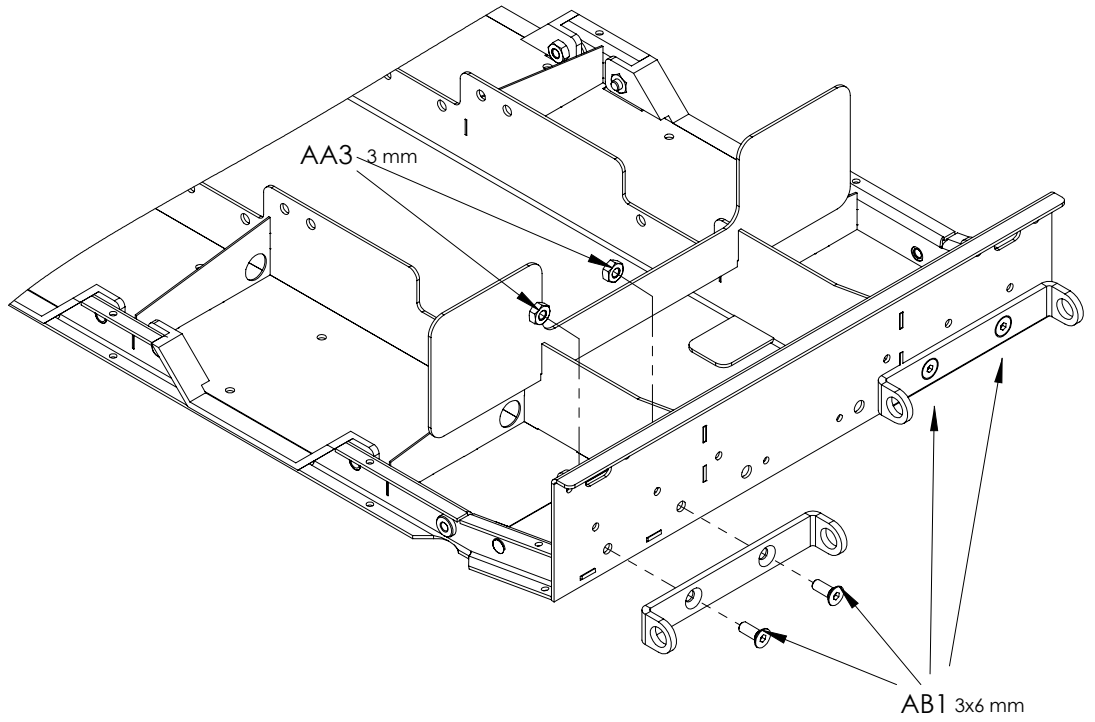

4

2 mm
Nut
Mutter



AA1 x 6

3x16 mm
Screw
Schraube

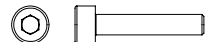

AD2 x2

2x8 mm
Screw
Schraube



AE4 x6

3 mm
Nut
Mutter



AA3 x 2

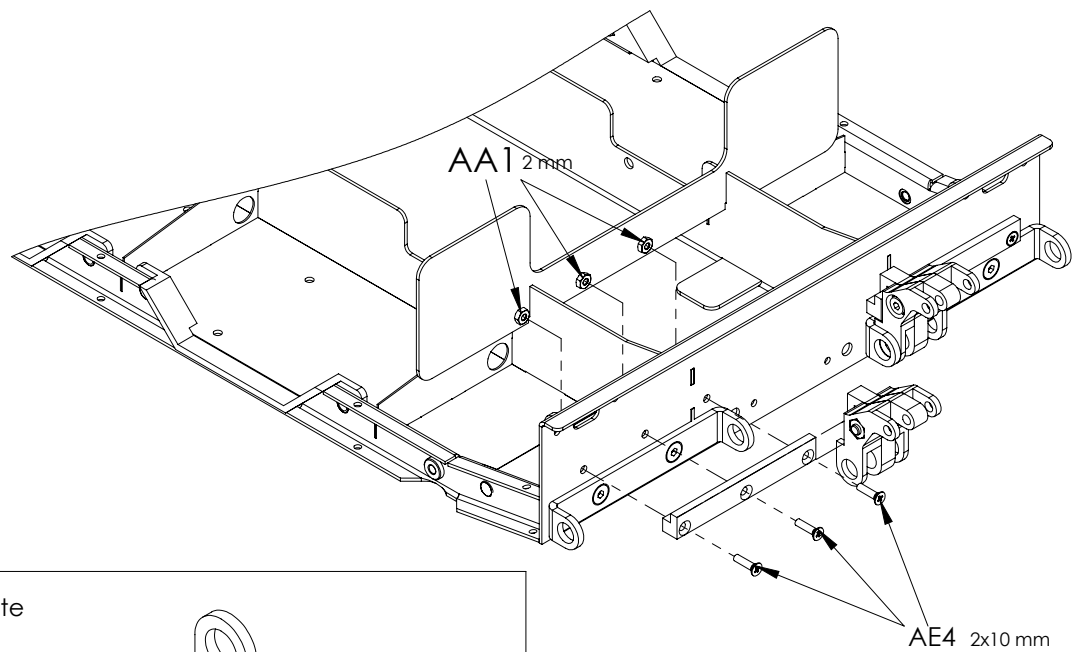

Rechte Seite
Right Side

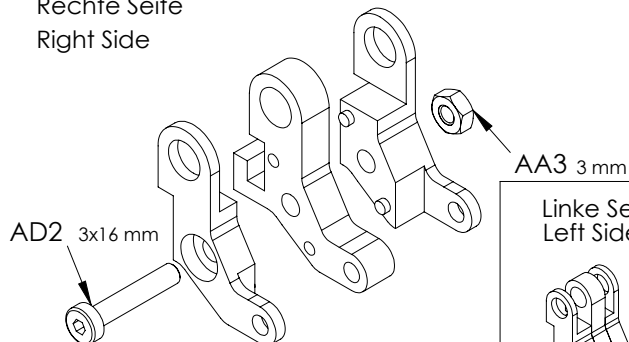

Linke Seite
Left Side

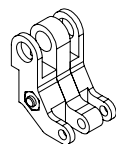

B 5 ~ 13
BAG B
BEUTEL B

2,2x6,5 mm
 Tapping Screw
 Schneide-
 schraube



AJ1 x18



Ball bearing
 Kugellager

AM 1x12

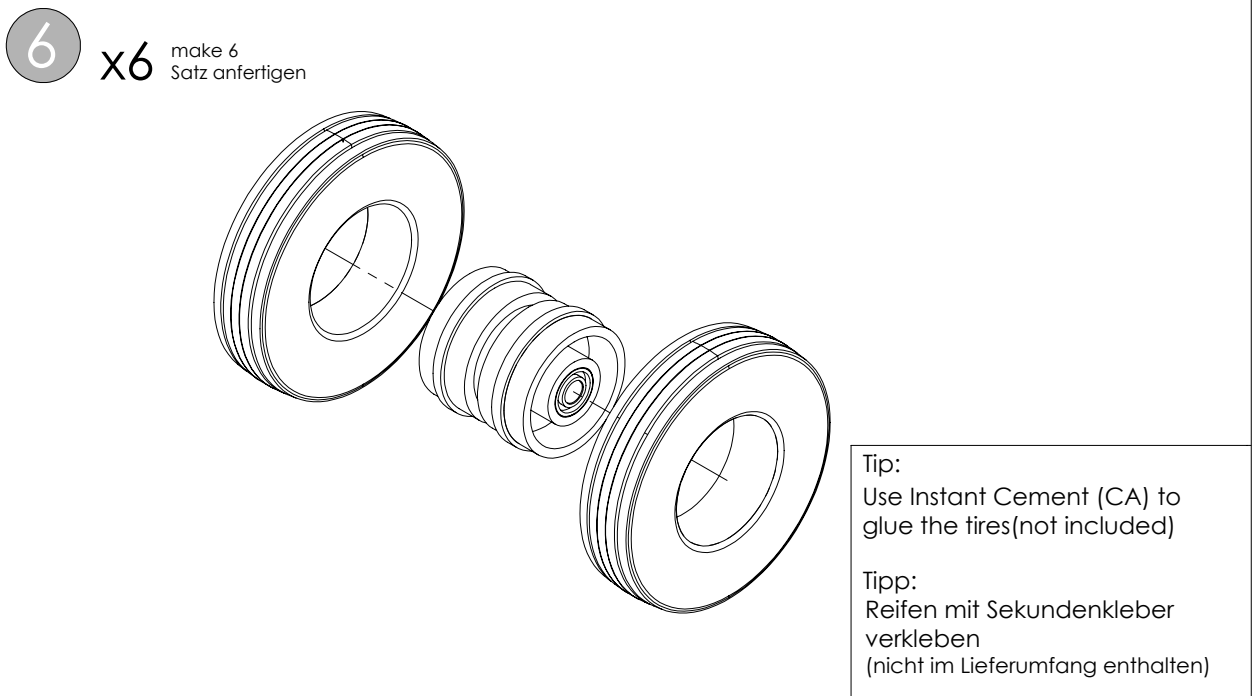
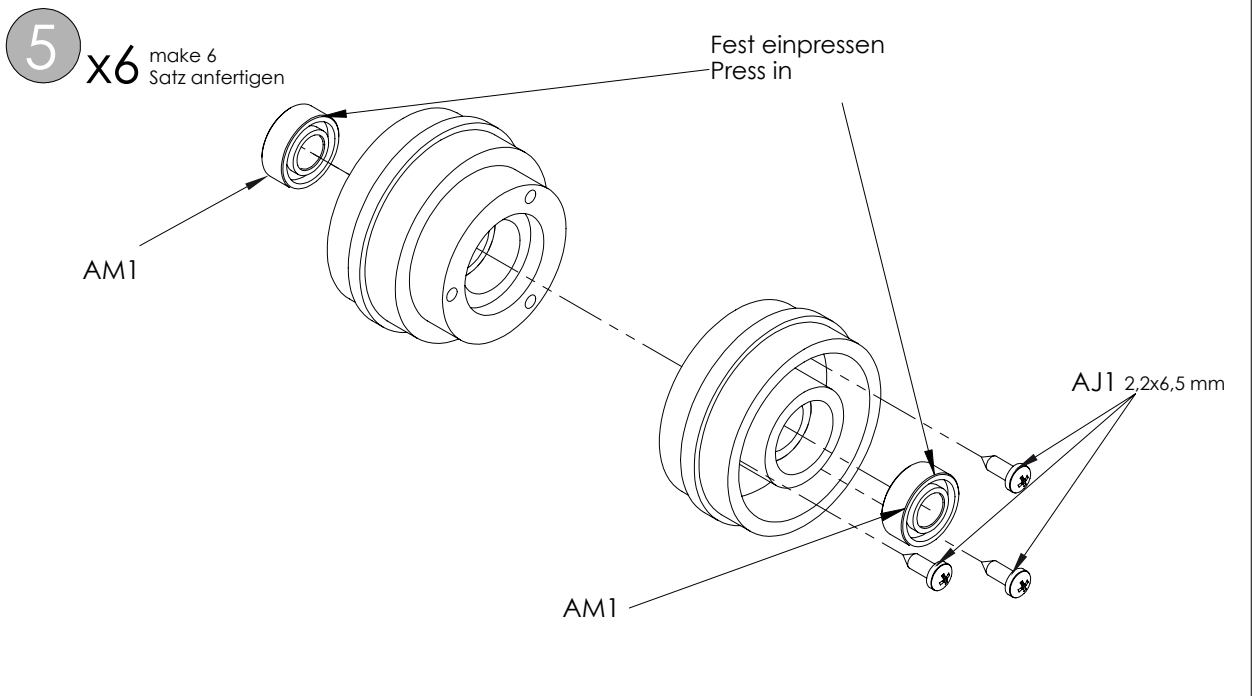

2 mm
 Nut
 Mutter



AA1 x12

3x14 mm
 Screw
 Schraube



AC1 x6

3 mm
 Sicherungs-
 mutter
 Lock nut



AA4 x6

5x8 mm
 Buchse (Stahl)
 Tube (Steel)



AK1

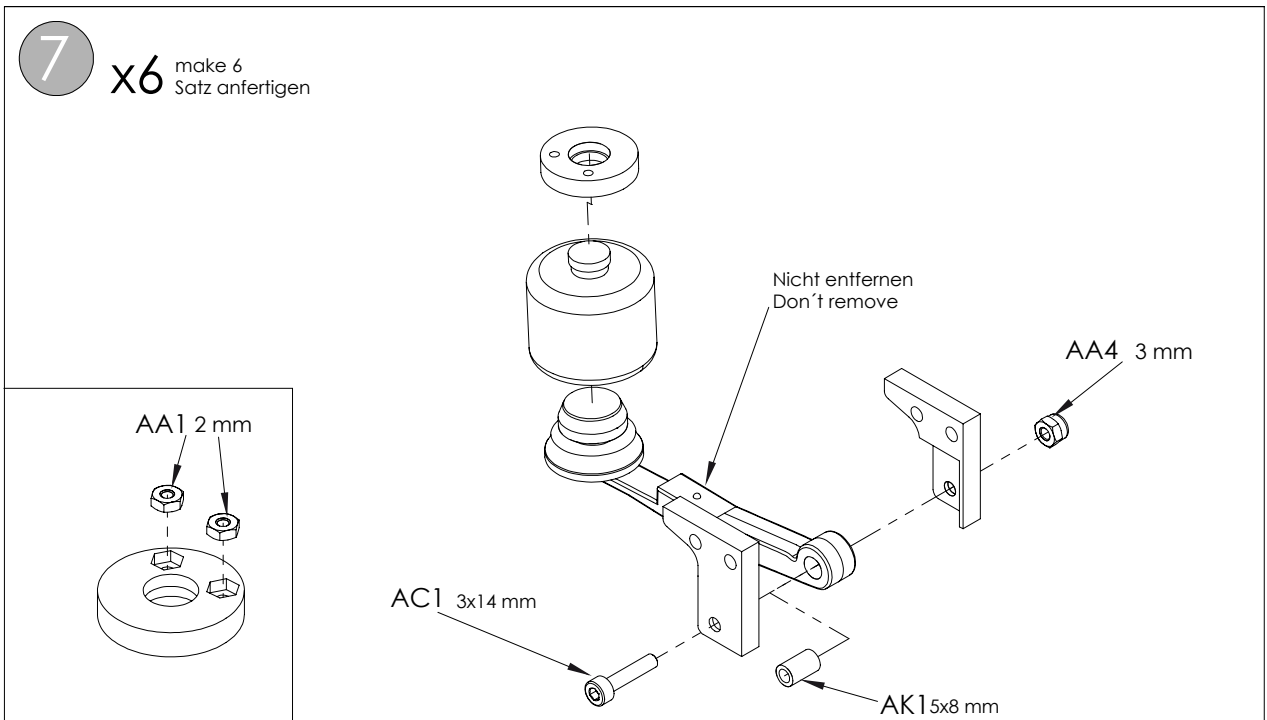

2,6 mm
Nut
Mutter



AA2 x24

8 x3 make 3
Satz anfertigen

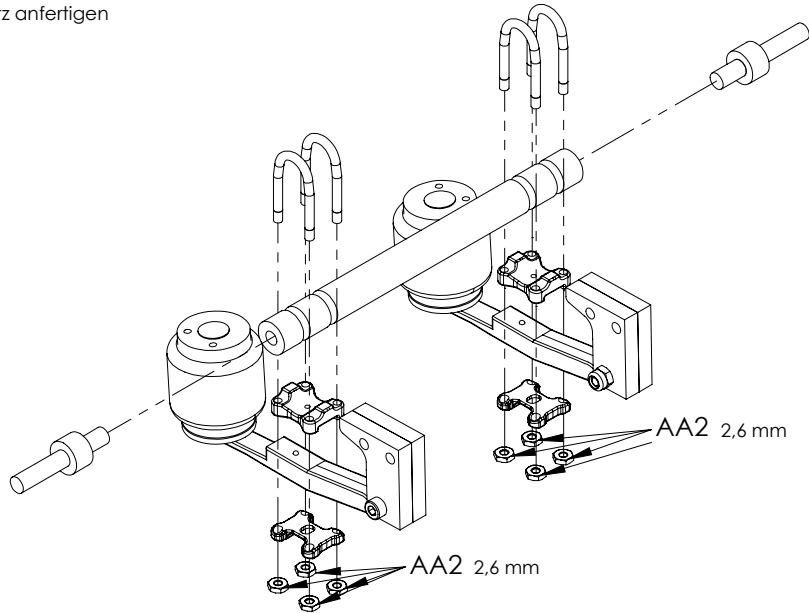

5 mm
Lock nut
Stoppmutter

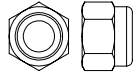

AA5 x6

9 x3 make 3
Satz anfertigen

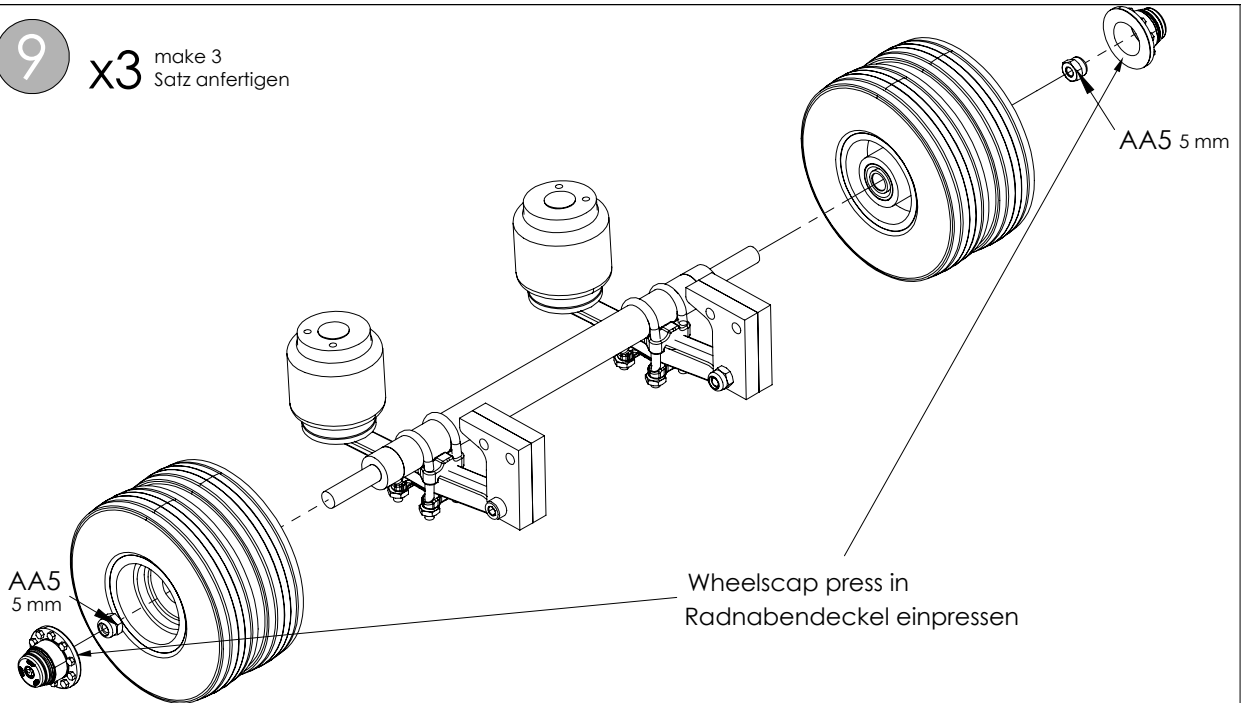

2x5 mm
Screw
Schraube



AC3 x12

10 x3 make 3
Satz anfertigen

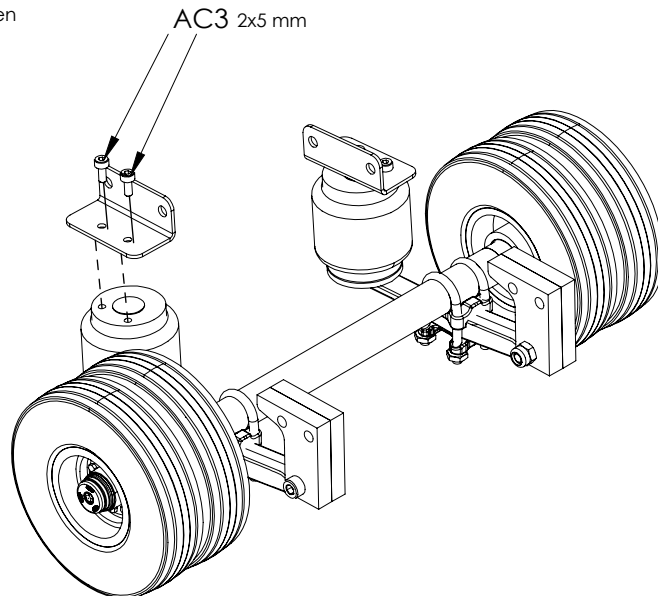

3x8 mm
Screw
Schraube



AB2 x2

3x4 mm
Screw
Schraube



AC2 x4

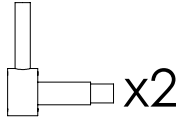

x2

11

Aufliegerstütze vorne
Front supportlegs

x2 make 2
Satz anfertigen

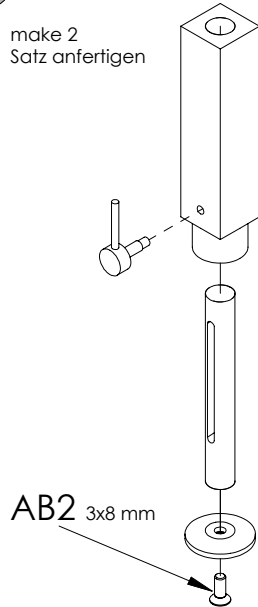

AB2 3x8 mm

Rechte Seite
Right Side

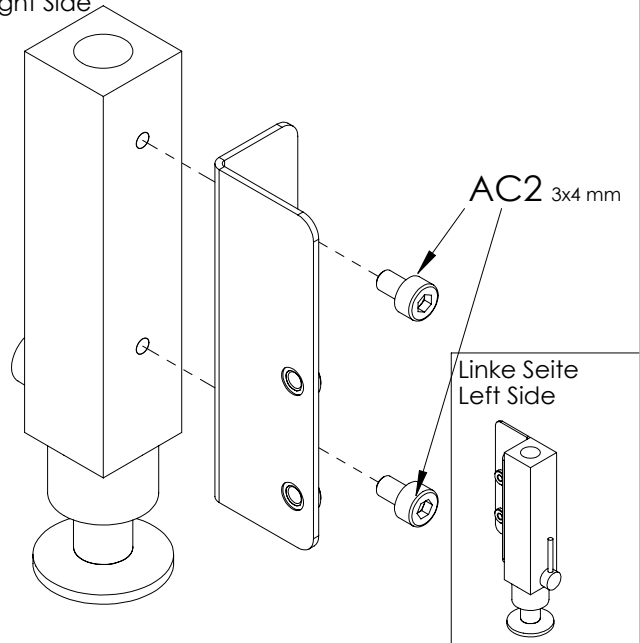

AC2 3x4 mm

Linke Seite
Left Side

12

Aufliegerstützen hinten
Rear supportlegs

x2 make 2
Satz anfertigen

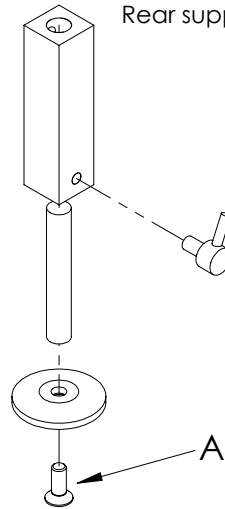

AB2 3x8 mm

3x8 mm
Screw
Schraube



AB2 x2

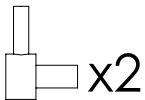

x2

13

x2 make 2
Satz anfertigen

Vorsichtig einpressen
Carefully press in

Tipp:
verkleben
glue in

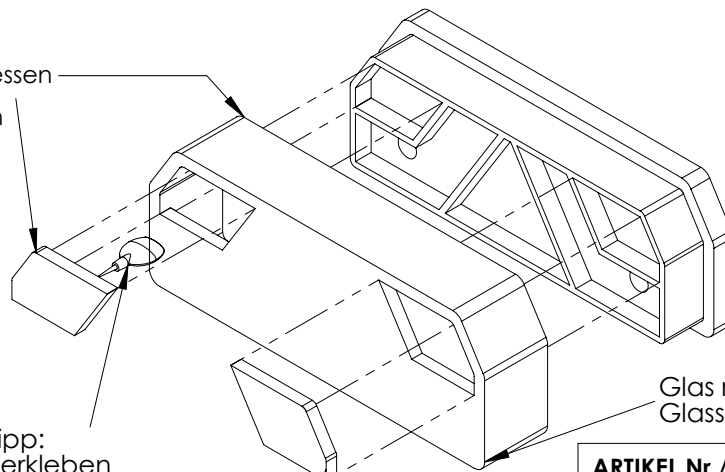

Glas Transparent
Glass clear

Glas rot
Glass clear red

ARTIKEL.Nr / ITEM.NO: 50090701

OPTION:
Beleuchtungssatz 7 - Kammer - Rückleuchten
(für Tamiya MFC-01)

Light kit 7 - section tail light
(fits Tamiya MFC01)

C14 ~ 19
BAG C
BEUTEL C

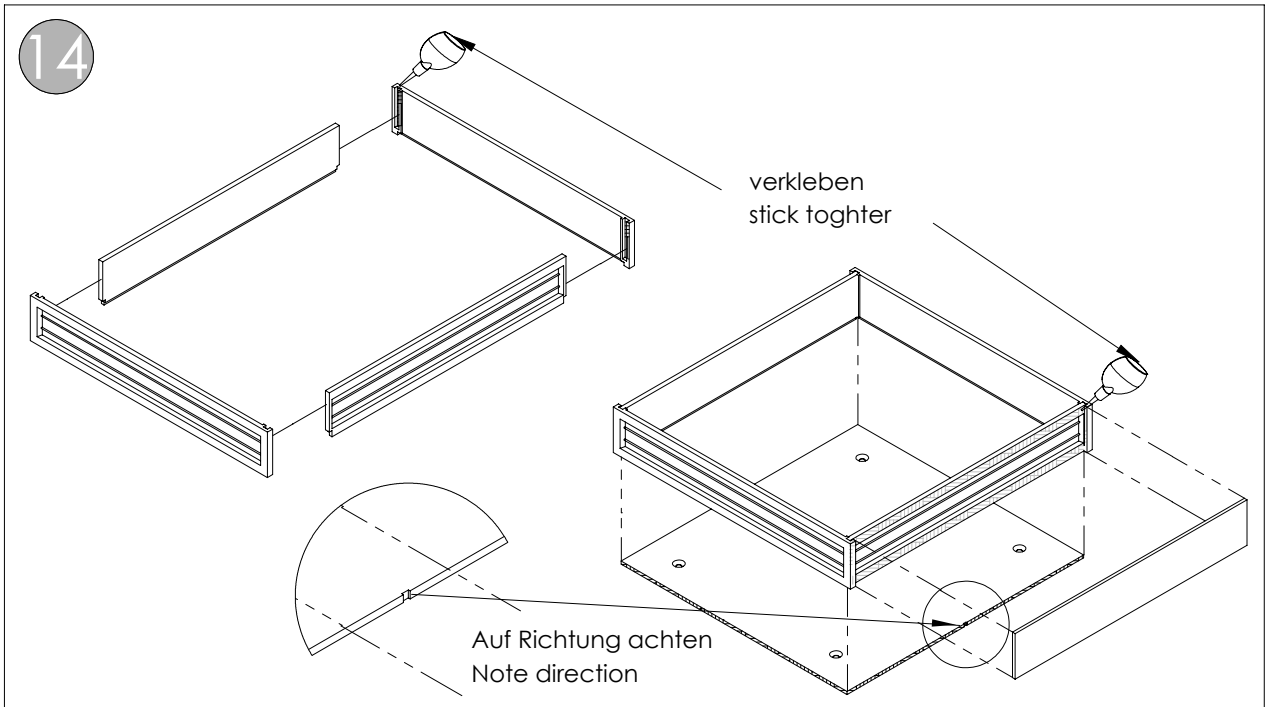

2x6 mm
Screw
Schraube



AE2 x4

2 mm
Nut
Mutter



AA1 x2

2x6 mm
Screw
Schraube



AE3 x2

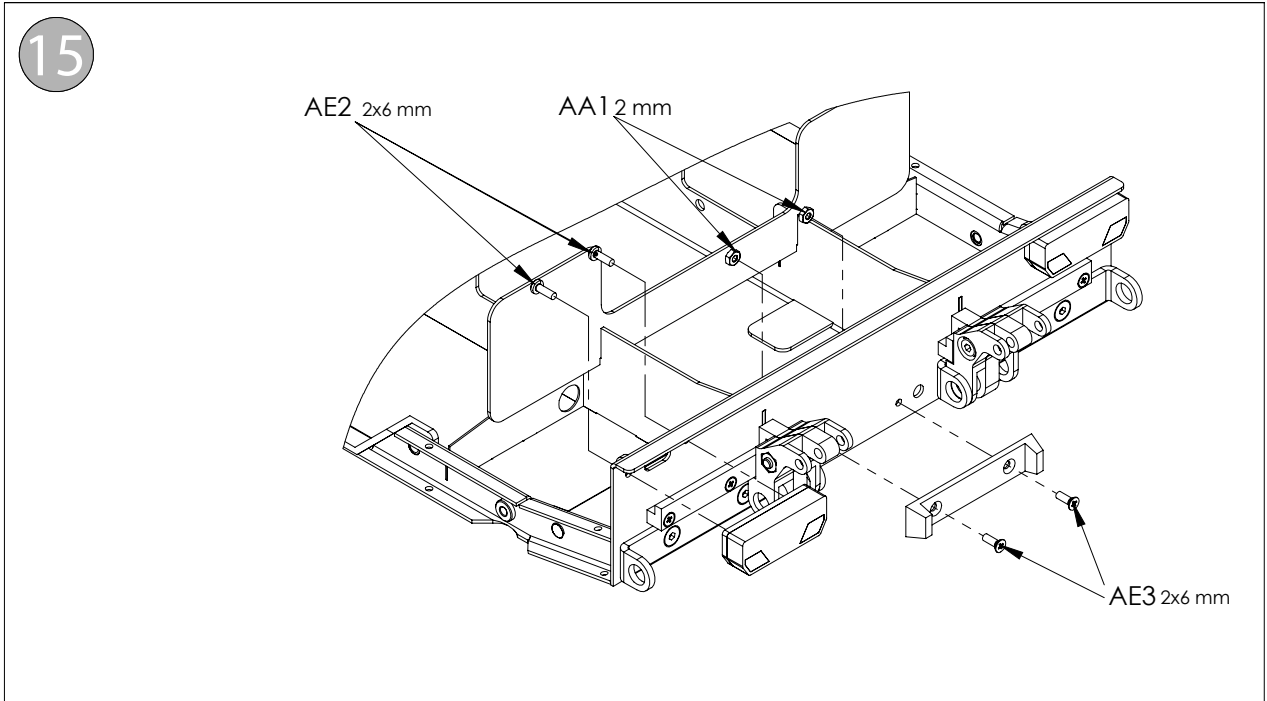

3 mm
Washer
Beilagscheibe



AF1 x4

3x4 mm
Screw
Schraube

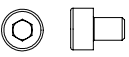

AC2 x4

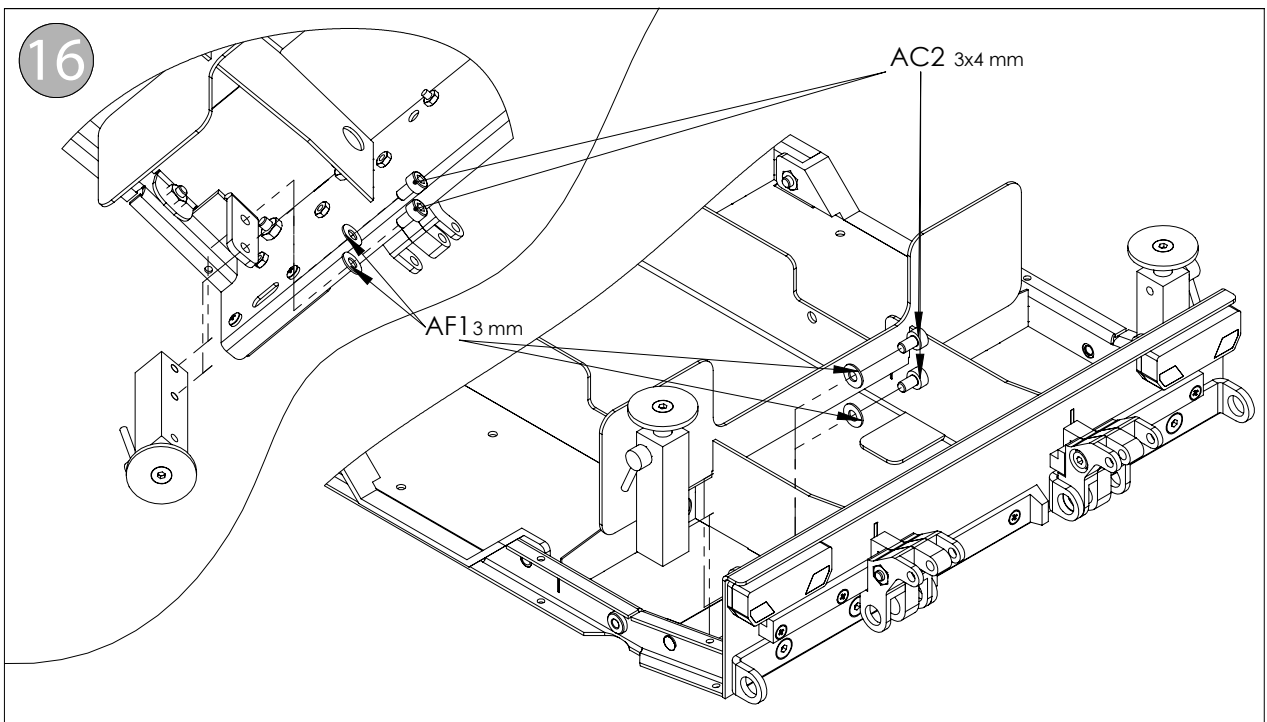

3x6 mm
Screw
Schaube

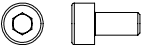

AC4 x4

3x16 mm
Screw
Schaube

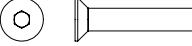

AB3 x1

17

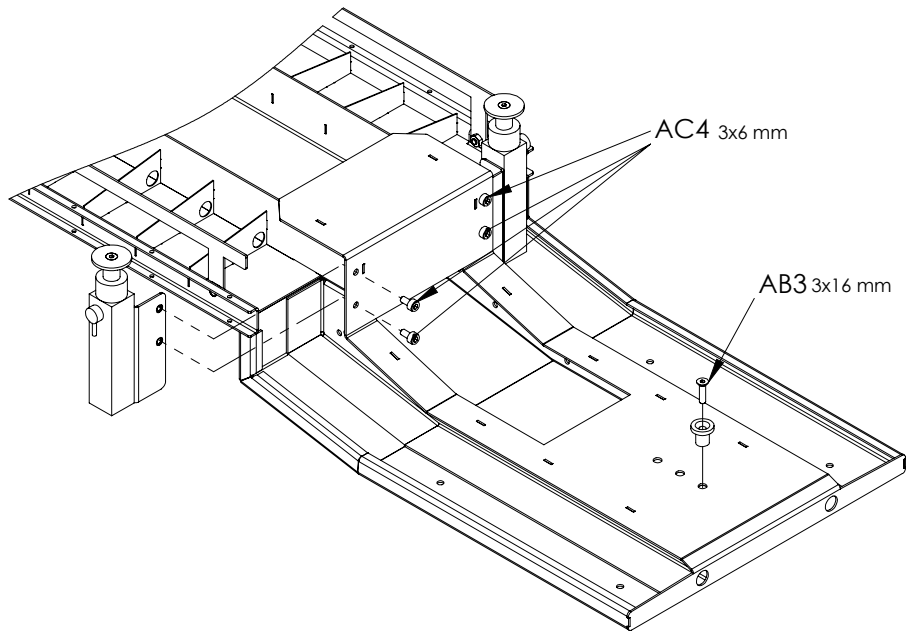

3x14 mm
Screw
Schaube

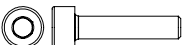

AC1 x12

3 mm
Nut
Mutter



AA3 x24

3x6 mm
Screw
Schaube

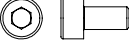

AC4 x12

18

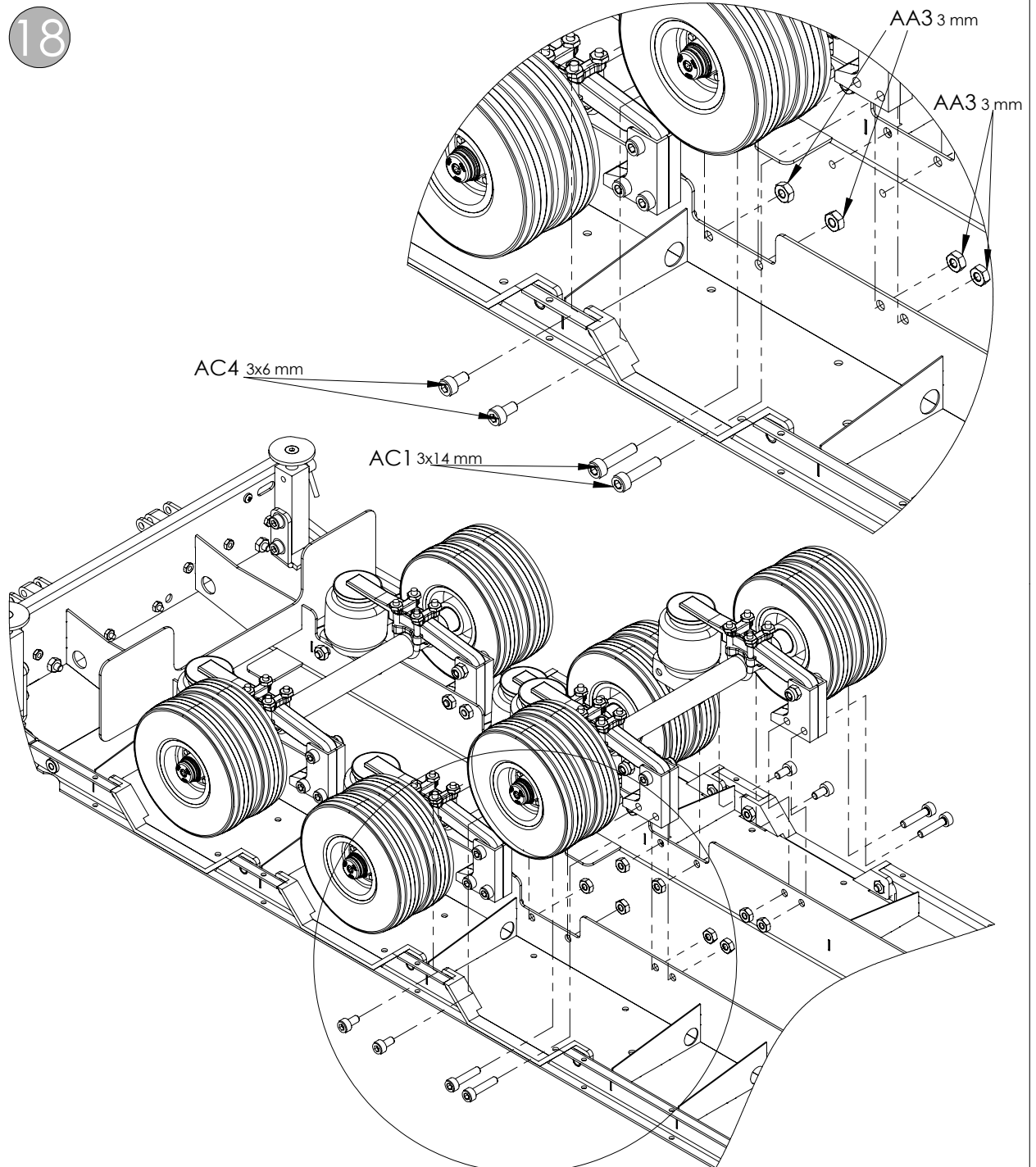

3x6 mm
Screw
Schraube



AB1 x4

3 mm
Nut
Mutter



AA3 x4

19

Auf die „NUT“ achten
Note „Groove“ direction

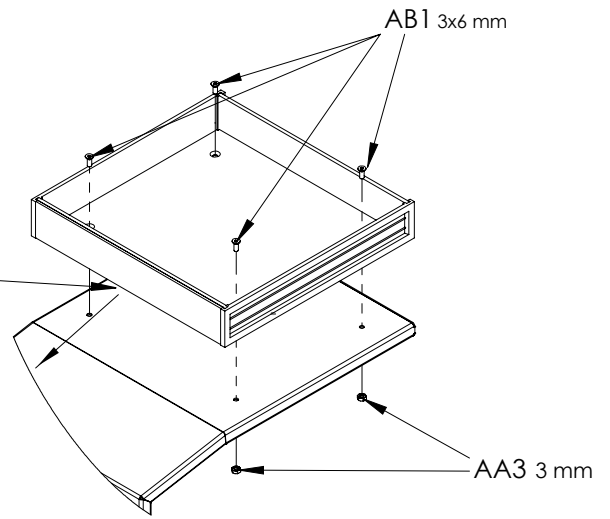

D20 ~ 33
BAG D
BEUTEL D

3x6 mm
Screw
Schraube



AB1 x6

3x6 mm
Screw
Schraube



AD1 x4

3x6 mm
Screw
Schraube



AI1 x2



20

Links Seite
Left side

AB1 3x6 mm

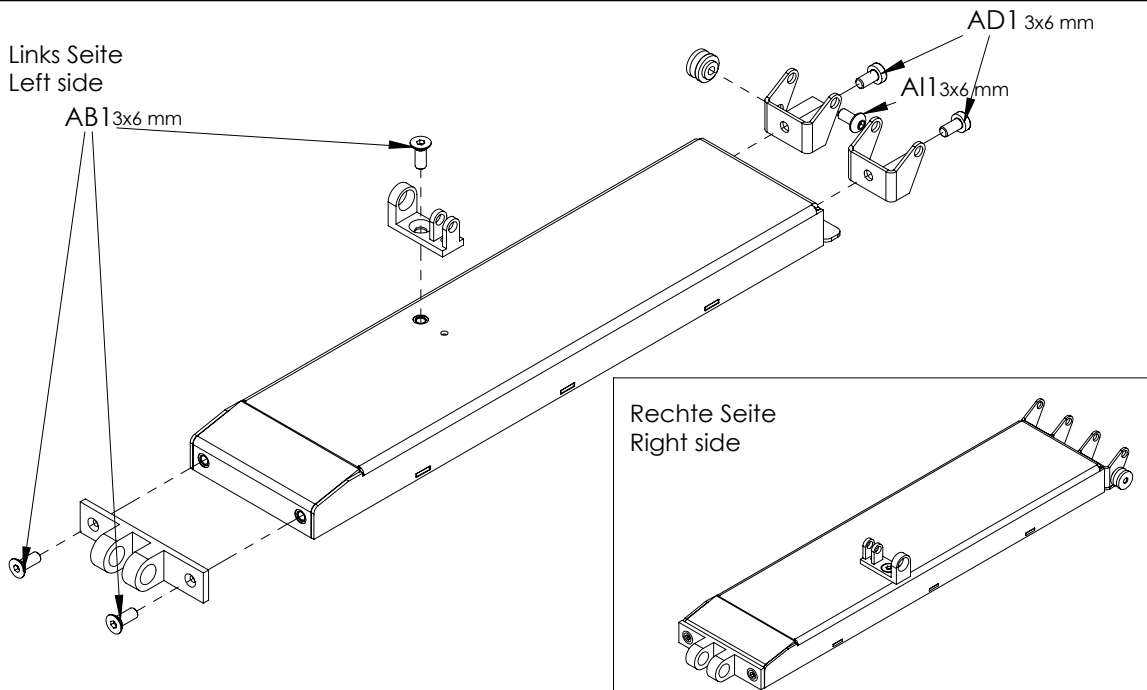

Rechte Seite
Right side

21

Rechte Seite
Right side

2x12 mm
Screw
Schraube

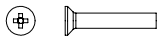

AE5 x2

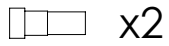

x2



x2

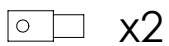

x2

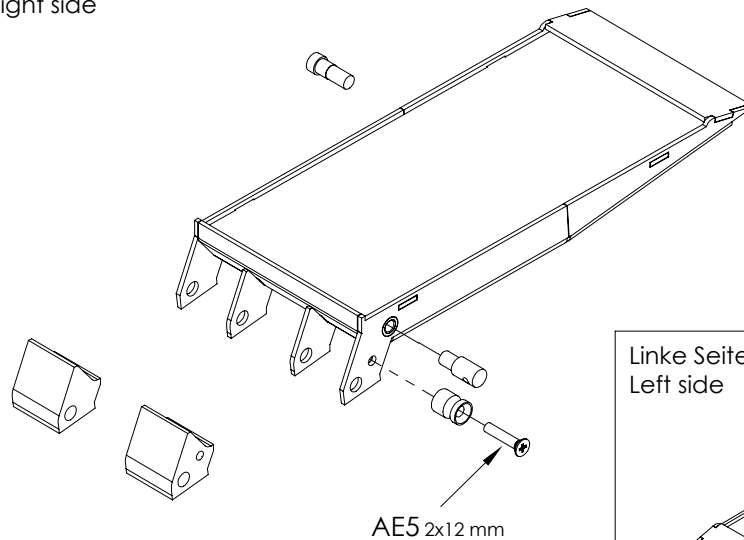

Linke Seite
Left side

2,3 mm

Sicherungsring
Snap ring



AG1 x4

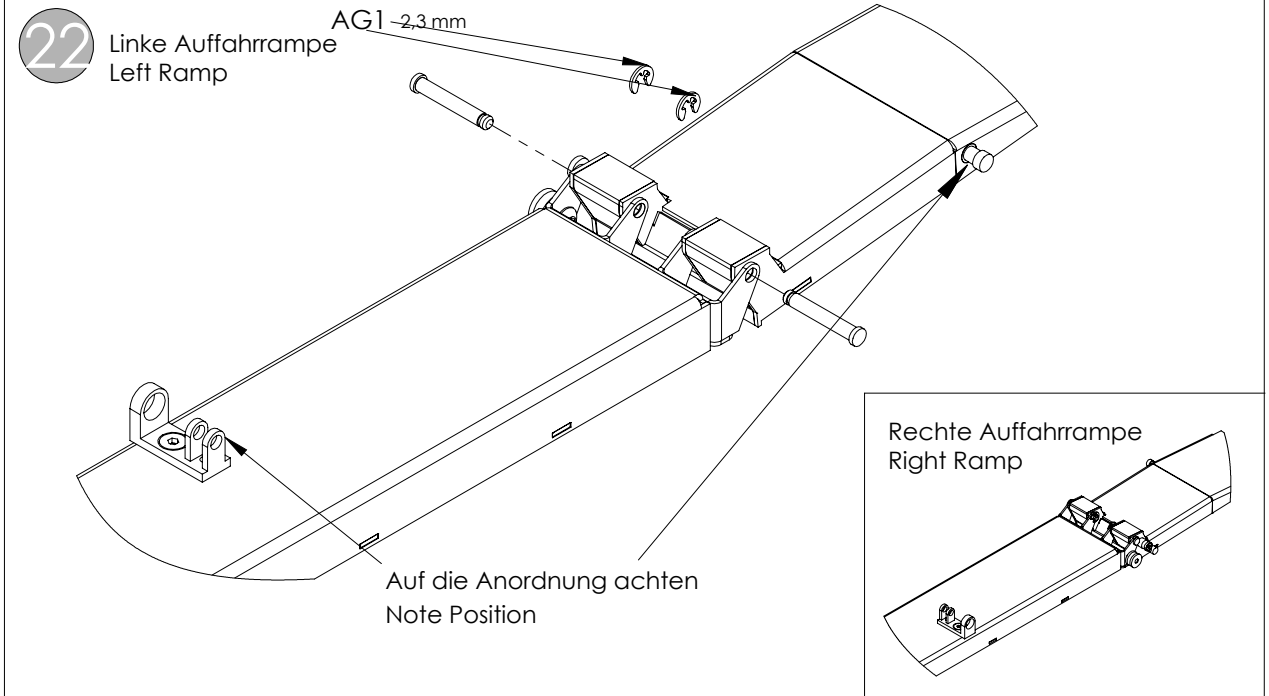
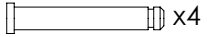

23 Linke Seite
Left side

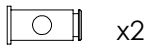
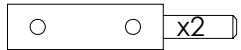

Zylinder Satz A Benutzen
Use cylinder set A

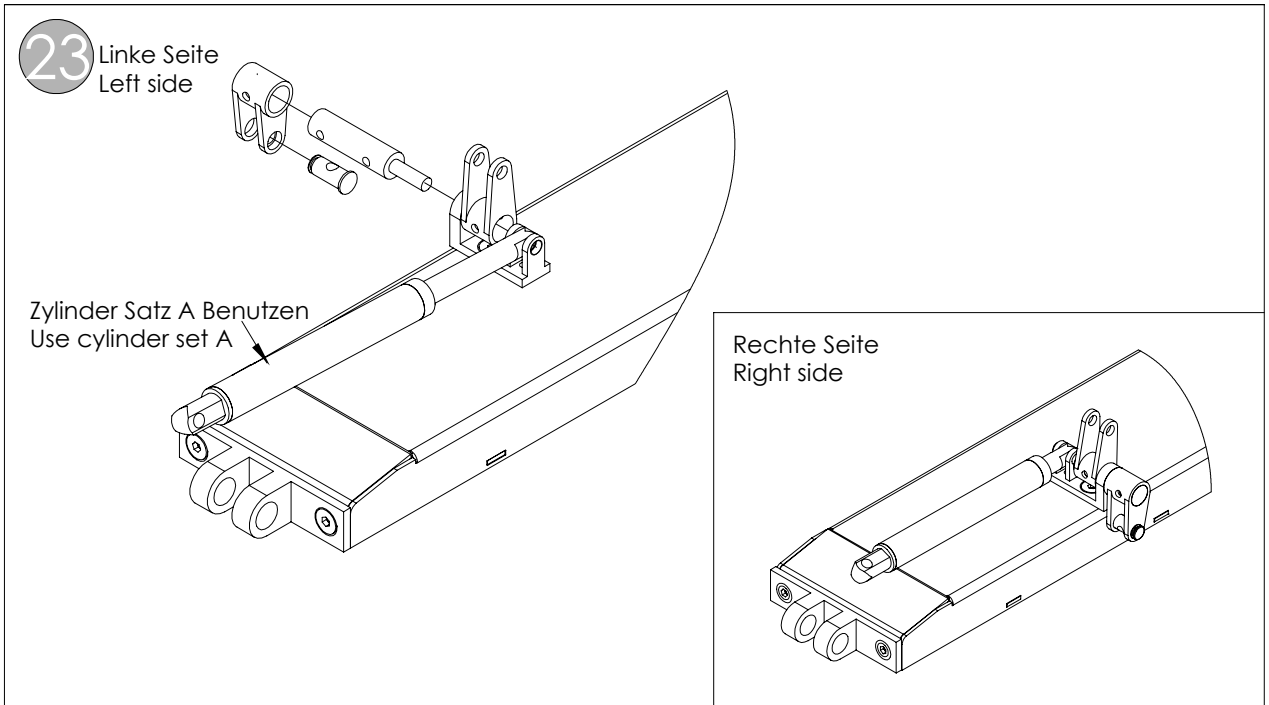

2x8 mm
Zylinderstift
Parallel pin

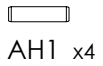

2,3 mm
Sicherungsring
ring

AG1 x2

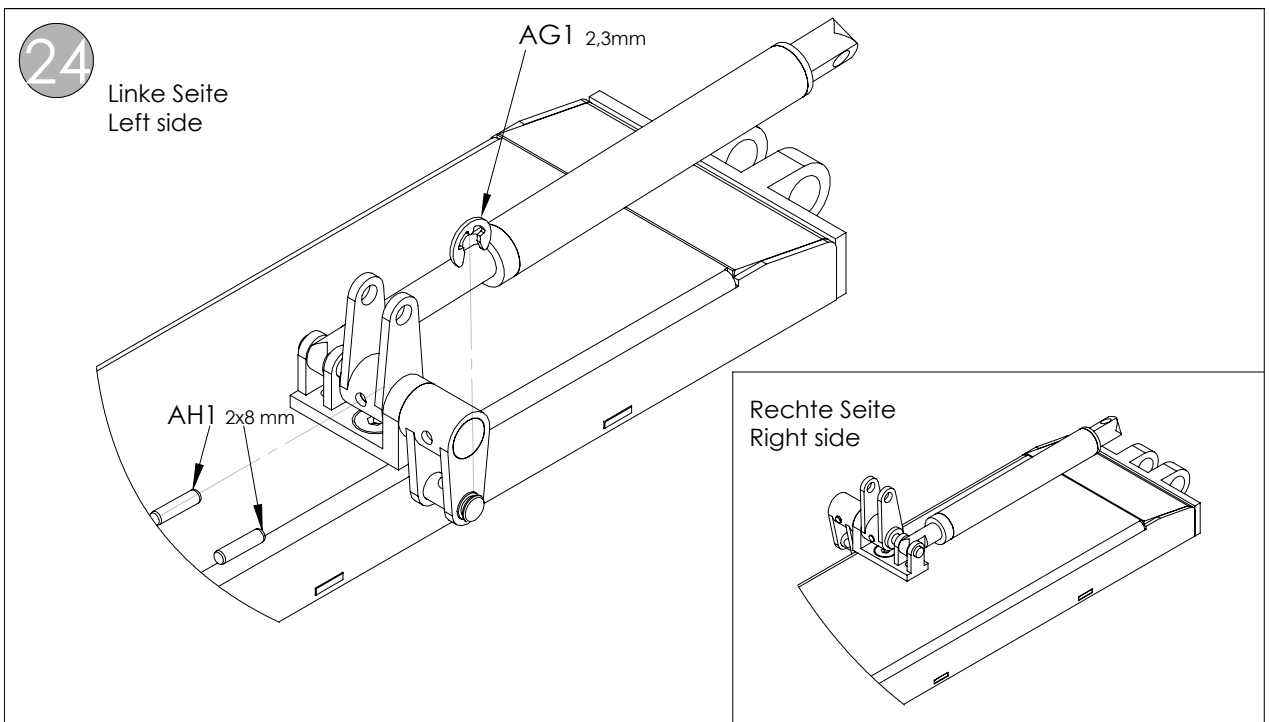

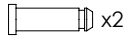

2,3 mm
Sicherungs-
ring
Snap ring



AG1 x2

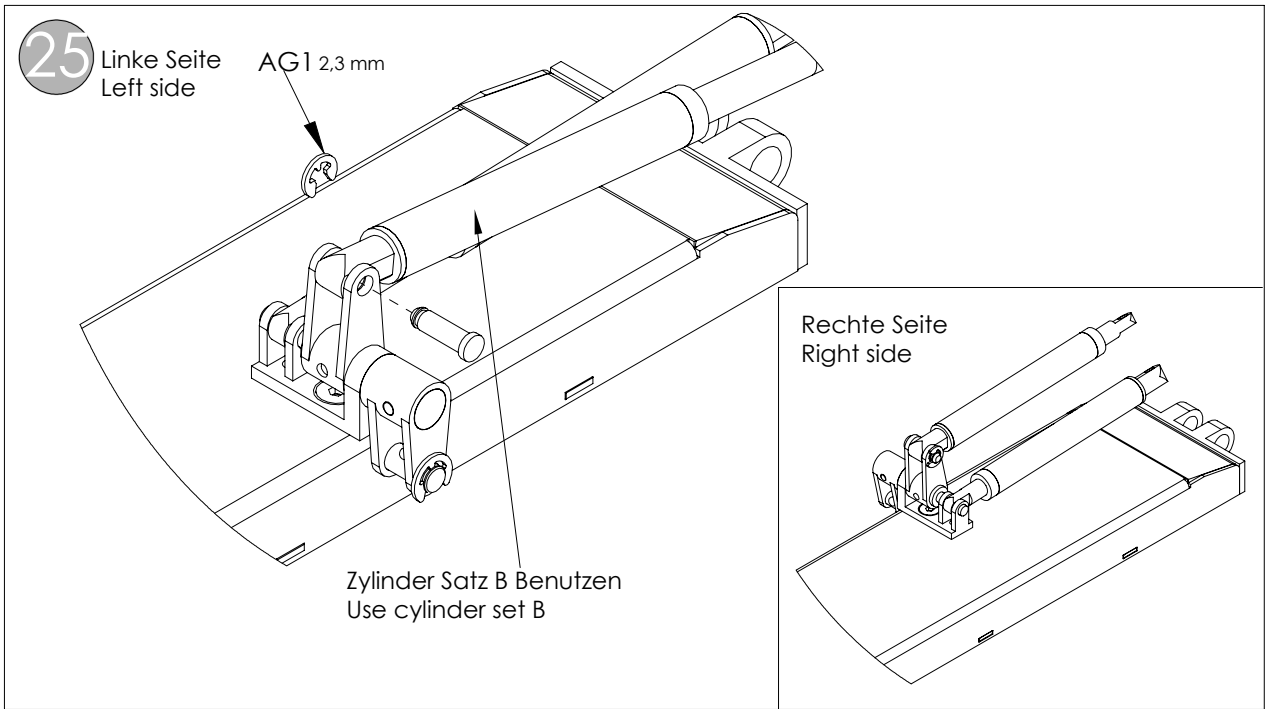

4 mm
Sicherungs-
ring
snap ring



AG4 x4

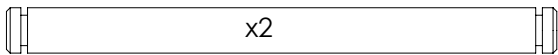
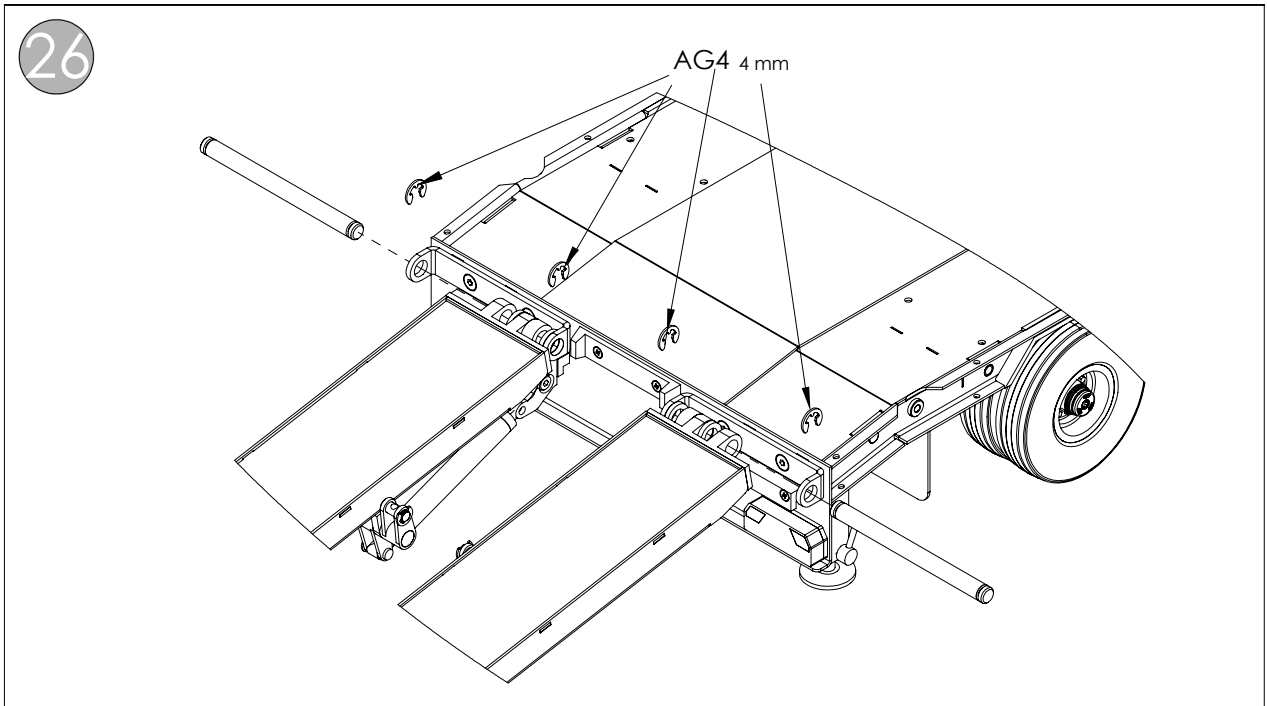

x2

2,3 mm

Sicherungs-
ring
Snap ring



AG1 x2

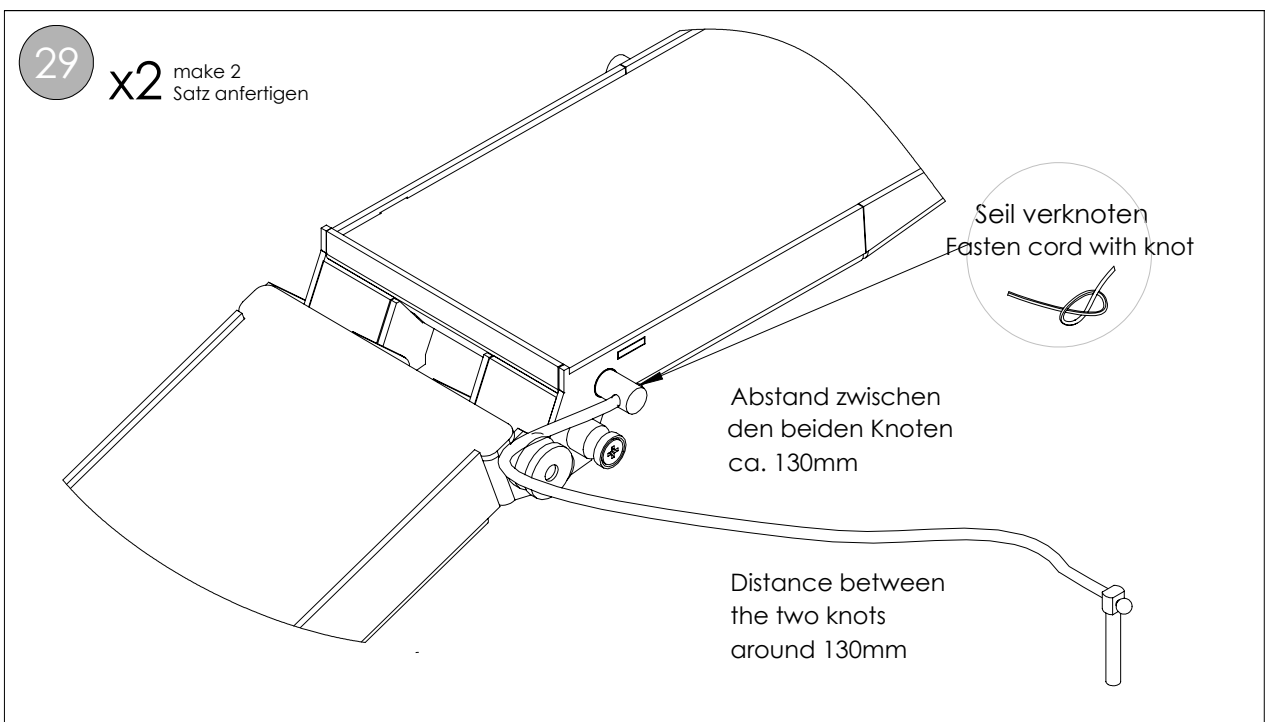
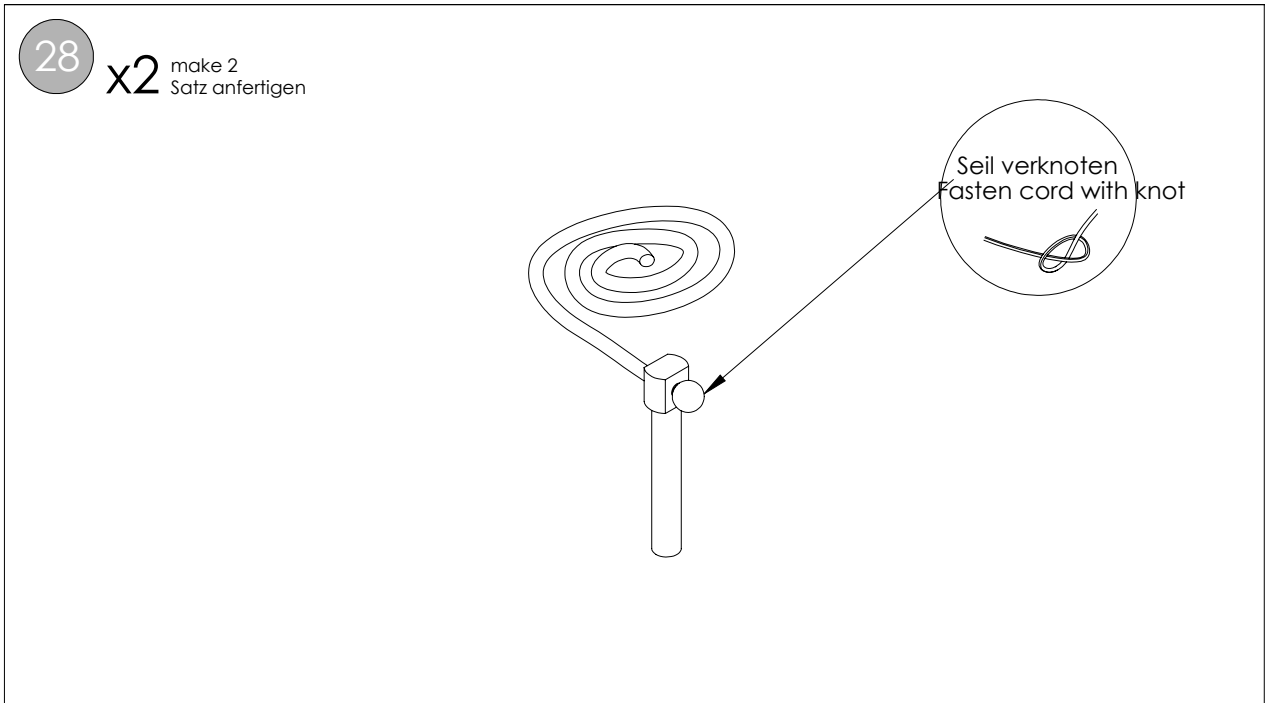
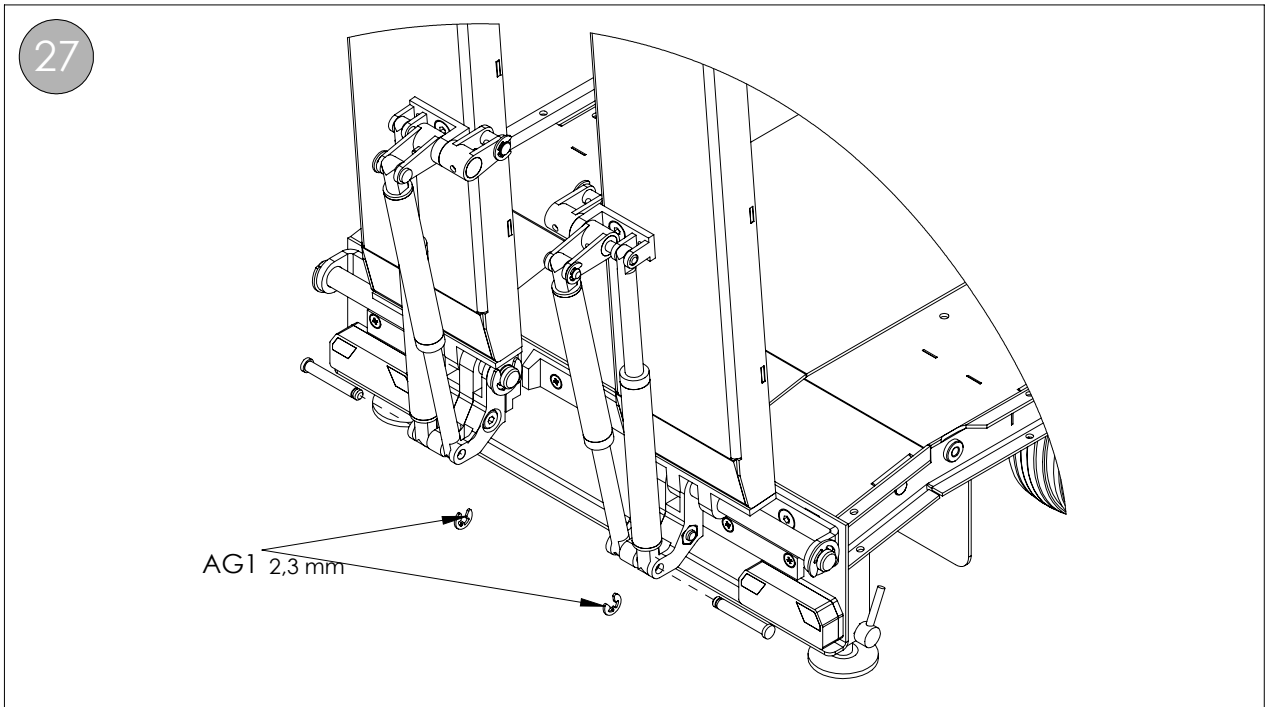



AA1 x2

2 mm
Nut
Mutter

30

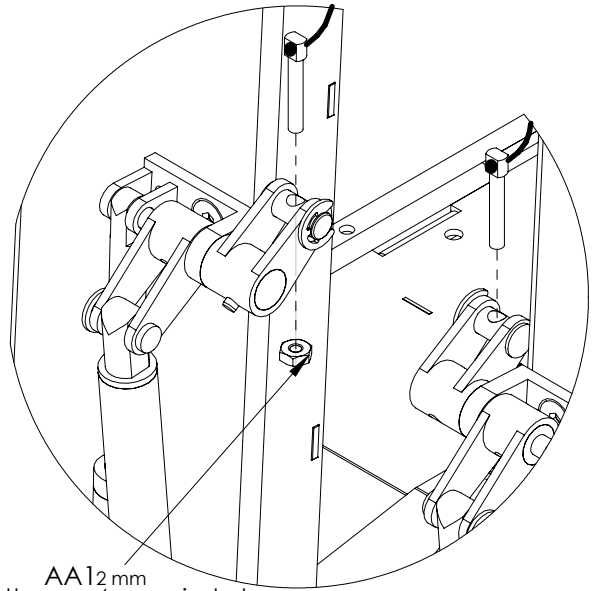
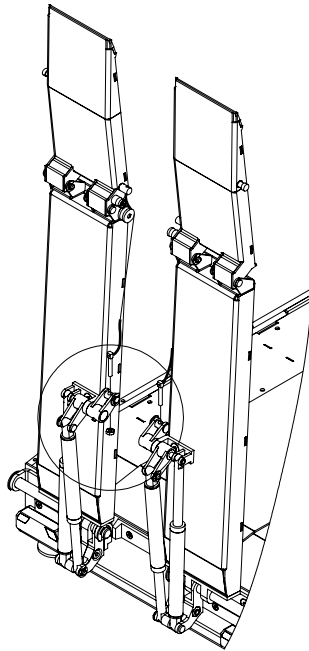

AA1 2 mm
Mutter ca. 4 mm eindrehen
Nut screwed about 4 mm

Nach dem Anziehen der Mutter M2 (AA1) die Funktion der kleinen Rampe prüfen.
Sollte diese nicht ausklappen Mutter M2 (AA1) nachstellen.

After having screwed nut M2 (AA1) please check the function of the small ramp.
If this doesn't lower, please adjust nut M2 (AA1)

31

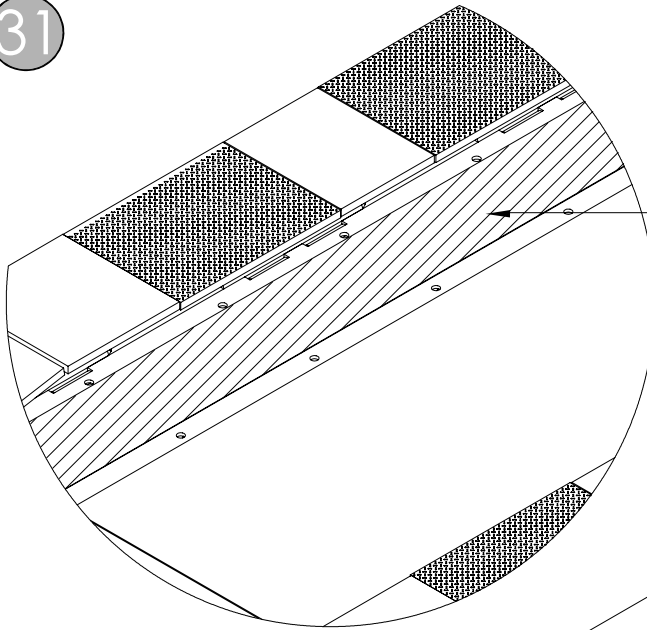

Doppelseitiges Klebeband verwenden
(Nicht im Lieferumfang enthalten)

Use double-faced adhesive tape
(not included)

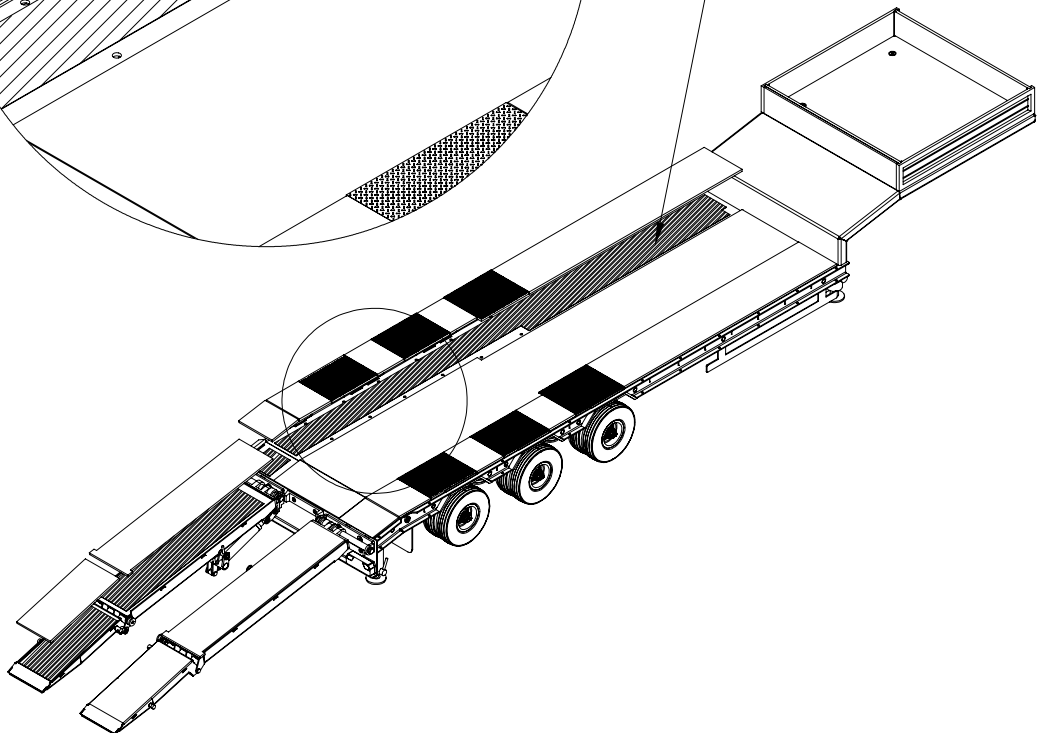

32

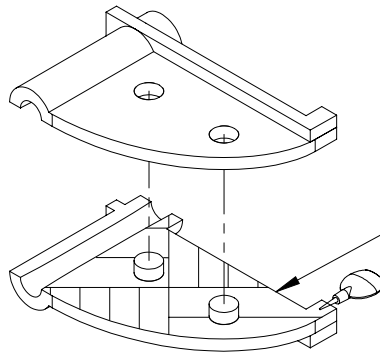

Verkleben
Stick togher

make 20
20 Satz anfertigen

33

2x16 mm

Zylinderstift
Parallel pin

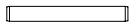

AH2 x20



x2

AH2 2x16 mm

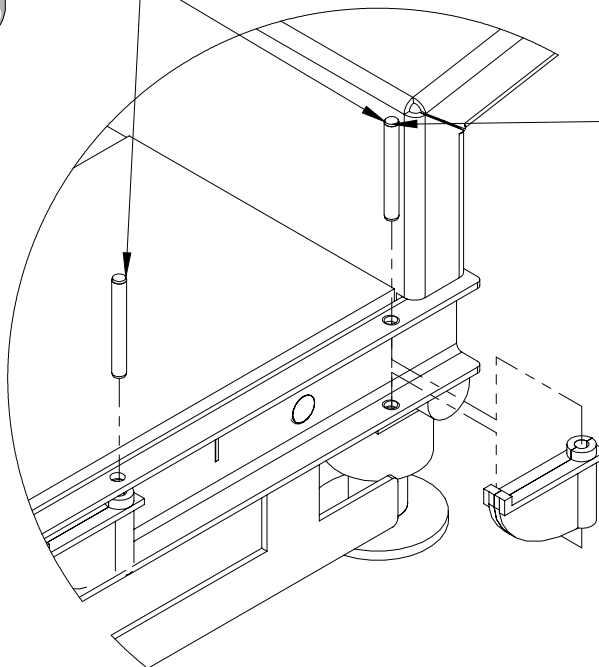

Vorsichtig einklopfen
Gently pat the pin

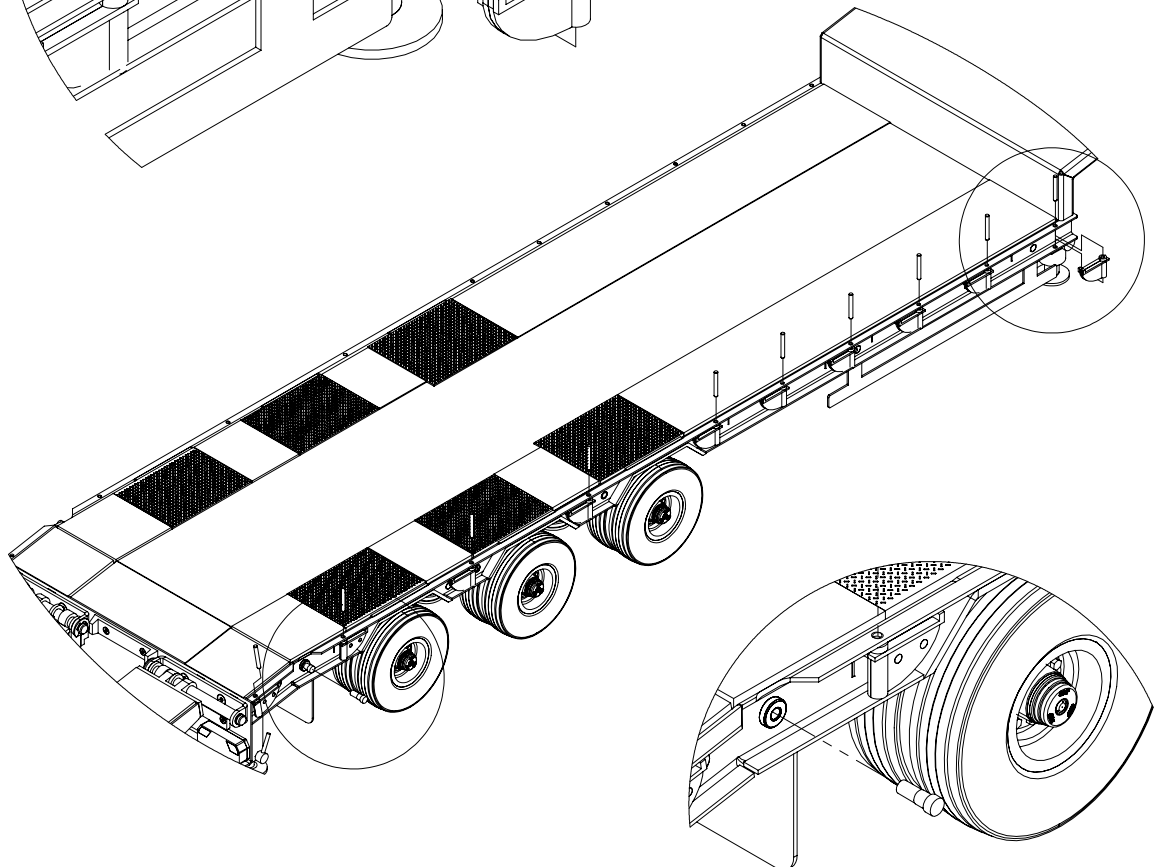



TAMIYA-CARSON
Modellbau GmbH & Co. KG

Werkstraße 1 // D-90765 Fürth // www.carson-modelsport.de

03675 7333 343

Service-Hotline for Germany: Mo-Do 8.00-16.00 Uhr // Fr 8.00 -12.30 Uhr
Carson-Model Sport // Abt. Service // Mittlere Mutsch 9 // 96515 Sonneberg
www.service.carson-modelsport.com